

FOLLOW THESE ADDITIONAL STEPS WHEN INSTALLING A SYSTEM UNDER HARDWOOD FLOOR COVERING

STEP 1: INSTALL WOOD SLEEPERS

Install wood sleepers (strips of wood 1" to 2" wide and 3/8" to 1/2" high) 19" apart across the entire plywood subfloor leaving appropriate space for any planned cuts and turns. The sleepers are installed to create lanes into which the 18" wide warming system roll will be placed.

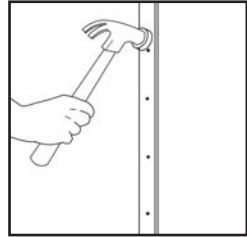

STEP 2: LAY HEATING SYSTEM

Lay the floor heating system into the 19" lanes created by the sleepers, carefully stringing the power leads alongside the system within the lane and back to the power supply.

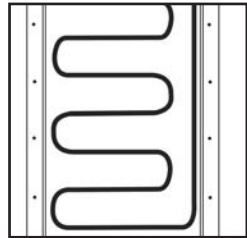

STEP 3: COVER ROLLS WITH SELF LEVELING CEMENT

Once the system is in place, the warming roll should be covered with self leveling cement up to and even with the top of the wood sleepers.

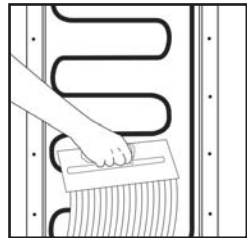

STEP 4: INSTALL HARDWOOD FLOORING

Once the self leveling cement has dried and cured to the manufacture's specifications the hardwood floor can be installed by nailing it into the wood sleepers. Be careful not to place nails or staples near to the system's heating cable or power leads.

