

## TOOLS REQUIRED

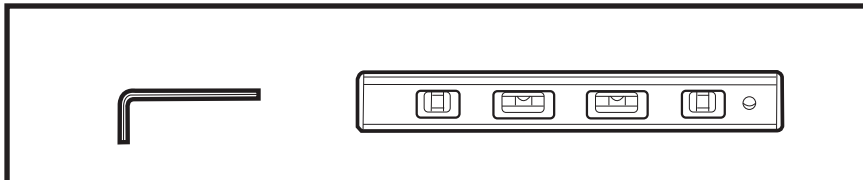

## INSTALLATION INSTRUCTIONS

- Review instructions carefully before installation
- Installation should be completed by a qualified person
- Please dispose of packaging in a responsible manner

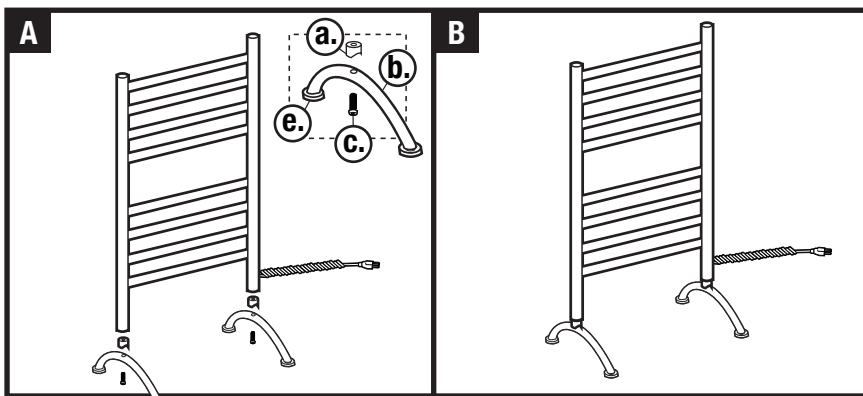
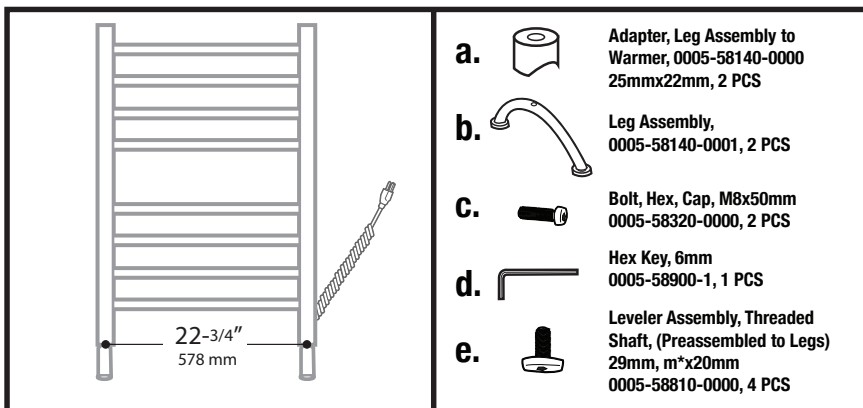

Please note that part **e** is already mounted to part **b** in the box. After installation is complete, connect the 5 foot electric power cord and turn on the Power Switch. The unit will begin to heat. If the unit will not be used for an extended time, simply turn the unit off using the power switch.

1. Do not hook the unit up to a circuit until completely reading these instructions.
2. This product is intended only for domestic use. Do not put the unit into water. Do not use in a sauna, shower cubicle or steam room. This product is for indoor use only.
3. If the heating wire inside the unit fails or becomes damaged, turn the unit OFF and contact WarmlyYours. Do NOT attempt to repair or remove the power switch or heating wire.
4. If you encounter any difficulties while installing your Towel Warmer, installation support is available by phone, 24/7 at (800) 875-5285.
5. If a return is necessary, please use original packaging if possible.

**SAFETY INFORMATION**

- Towel Warmers are designed to warm towels only and should not be used for any other purpose.
- Never stand, sit on or hang on the Towel Warmer unit.
- Never allow children to play on or with the Towel Warmer.
- Make sure that the unit is unplugged before servicing your Towel Warmer.
- The Towel Warmer must be properly grounded.
- All wiring must be in accordance with the National Electrical Code (NEC) and Canadian Electrical Code (CEC) and should be performed by a licensed professional who is certified to do electrical wiring.
- Never place your Towel Warmer inside a shower, sauna or steam room.
- Never attempt to warm more than two (2) towels on the Towel Warmer at a time. Overloading the Towel Warmer will cause the unit to become extremely hot and may result in a burn if touched.
- Towel Warmers are cETLus listed for use in US and Canadian markets.
- Never use an extension cord.

**CLEANING INFORMATION**

Clean the Towel Warmer with a soft, non-abrasive, damp cloth while warm. Once the Towel Warmer has cooled, lightly polish with a soft dry cloth. Do not use abrasive cleaning powders, metal polish or chlorine based cleaners on any part of the Towel Warmer.

**INSTALLATION**

This appliance must be installed in accordance with the instructions in the manual and the NEC and CEC guidelines relating to electrical fixtures in bathrooms. The Towel Warmer must be on a GFCI protected circuit and be wired by a professional who is certified to do electrical wiring.