

# 01 BACKLIT MIRROR CABINET INSTALLATION

*Cabinet and cabinet door must be properly connected and installed to prevent unnecessary damages or accidents*

**Step 1** For recessed installation, slide in metal cabinet housing into rough-in opening in wall.

**For surface mounted installation,** mount metal cabinet housing to drywall or finished wall. Secure with screws and wall-plugs.

**Note:**

*To ensure that fixture is safely secured to the wall, fasten at least one side of the metal housing to a wall stud for extra support.*

**Step 2** Remove Power Cover to access ballast for wiring. (Feed in hardwires through knock-out. [Figure 1.2])

**Step 3** Connect hardwire to ballast to power cabinet lights. Place back cover when wiring is completed.

**Step 4** Mount glass shelves to shelf supports. Tighten bottom screw to secure glass. [Figure 1.3]

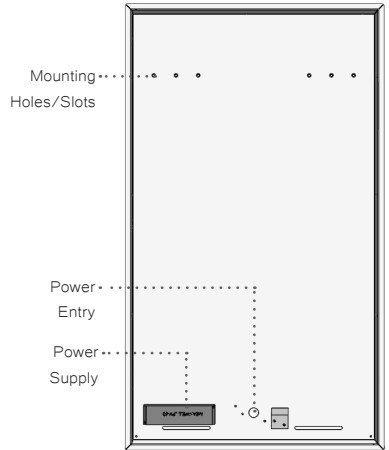

Figure 1.1

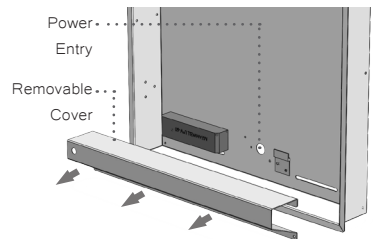

Figure 1.2

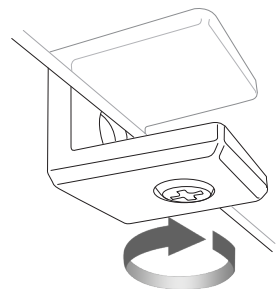

Figure 1.3

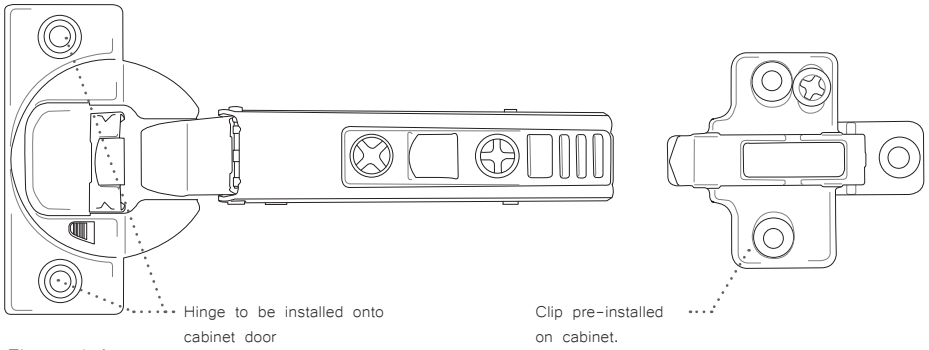

Figure 1.4

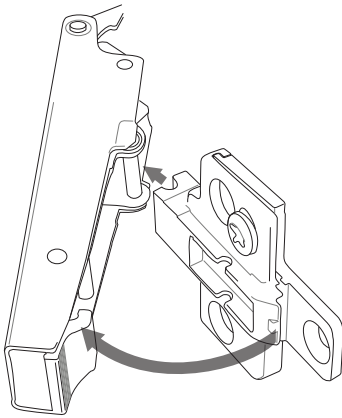

Figure 1.5

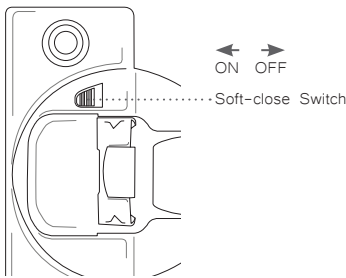

Figure 1.6

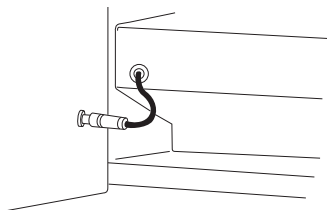

Figure 1.7

- Step 5** Take each hinge, place into pre-drilled holes in cabinet door. Secure hinges with screws. [Figure 1.4]
- Step 6** Carefully clip hinges to clips inside cabinet. Then push the hinge towards the clip until it snaps together. [Figure 1.5]
- Step 7** Adjust hinges' soft-close setting if necessary. Push switch left to turn soft-close mechanism on. Push right to turn soft-close mechanism off. [Figure 1.6]
- Step 8** Once cabinet door is installed, connect barrel connector from cabinet to cabinet door. [Figure 1.7] Close cabinet door and turn on wall switch. Lights should turn on without flickering.